

BRIDGE HOUSE SOUTH, BOSTON MANOR ROAD



£350,000

Tuffin & Wren are delighted to offer for sale this bright and spacious purpose-built apartment, situated just moments from Boston Manor's Piccadilly line Underground station and surrounding amenities and ideal for first time buyers and investors alike. The property is set on the top floor and boasts well-presented, generously proportioned accommodation and ample storage space, all accessed from a central hallway. Features include a bright, triple-aspect open-plan living/kitchen/dining room with modern fitted kitchen area, 2 good-sized bedrooms and a modern white bathroom suite. The apartment also benefits from a balcony/terrace at the rear of the property that overlook the beautifully-maintained communal gardens, a 900+ year lease and no onward chain.

TUFFIN & WREN

Independent Estate Agents

Contemporary Open-Plan Living Spaces



Modern Fitted Kitchen Area



Principal Bedroom



Bedroom 2



Beautifully Maintained Grounds



Further Information

For more details please call us on **020 8566 3366** or send an email to homes@tuffin-wren.co.uk.

Please note it is not our company policy to test services, heating systems and domestic appliances, therefore we cannot verify that they are in working order. Prospective purchasers are advised to obtain verification from their solicitors and/or surveyors.

Bridge House South

Approximate Gross Internal Area = 59.4 sq m / 639 sq ft

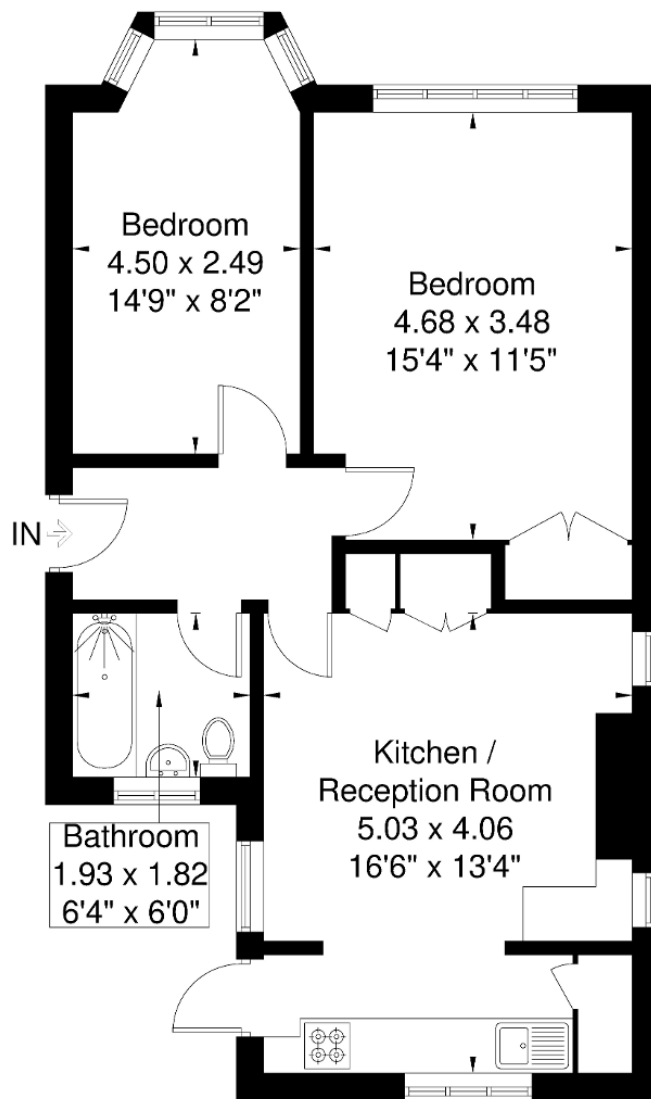

Third Floor

Although every attempt has been made to ensure accuracy, all measurements are approximate.
The floorplan is for illustrative purposes only and not to scale.
© www.perspective.co.uk

Energy Efficiency Rating			
Score	Energy rating	Current	Potential
92+	A		
81-91	B		
69-80	C		77 C
55-68	D		
39-54	E	44 E	
21-38	F		
1-20	G		